



► A&D Blood Pressure Monitor (UA-651 BLE)

In the box you will find:

- A&D Bluetooth Blood Pressure Monitor
- 4 – AA Batteries
- A&D Blood Pressure Cuff
- Travel Bag



Getting Started

- 1) Remove the blood pressure monitor, cuff, batteries and case from packaging.
- 2) Remove the battery cover on the back side of the monitor by sliding the cover in the direction of the arrow (A). Insert 4 batteries into the compartment and replace the cover.
- 3) Attach the cuff to the monitor, by inserting the plastic tip of the air hose into the socket (small hole) on the left side of the monitor. Push it in firmly until you hear a “click” (B).

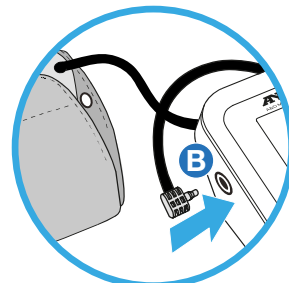
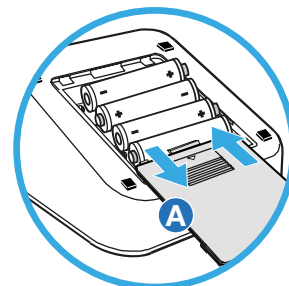

Pairing the Device and Using with the Hub

- 1) Make sure the **Vitals Hub is ON** – connected to power, displays a **SOLID RED** light (C), and located near the Bluetooth device while taking a reading.
- 2) Press and hold down the “start” button to activate the blood pressure monitor.
- 3) The screen will display “pr” [*Pr*] followed by “set” [*Set*] – after that release the “START” button.
- 4) When the screen displays “end” [*End*], the device is ready to use.
- 5) Place the cuff above your elbow with the white dot on the cuff facing your fingers. Wrap the cuff around your upper arm and pull the velcro end so the cuff fits snugly around your arm (D).
- 6) Press the START button on the monitor and the cuff will begin to inflate, tightening around the arm.
- 5) The **BLUE** light on the Hub will begin BLINKING, indicating the reading is being transmitted to electronic records. Once the **BLUE** light turns off, the transmission is complete.

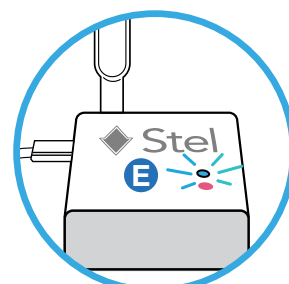
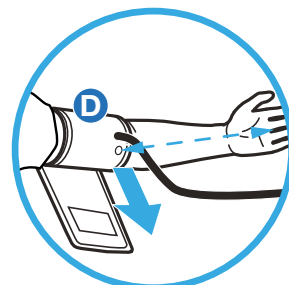
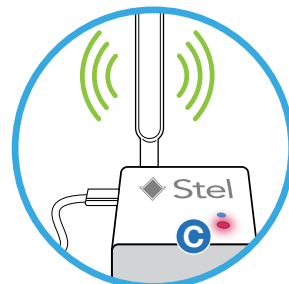

Note: If you have any questions – or if you don't see a blinking blue light after taking a measurement, please contact your care team for assistance.

 *Read the device manufacturer instructions for operation and safety before use.*